

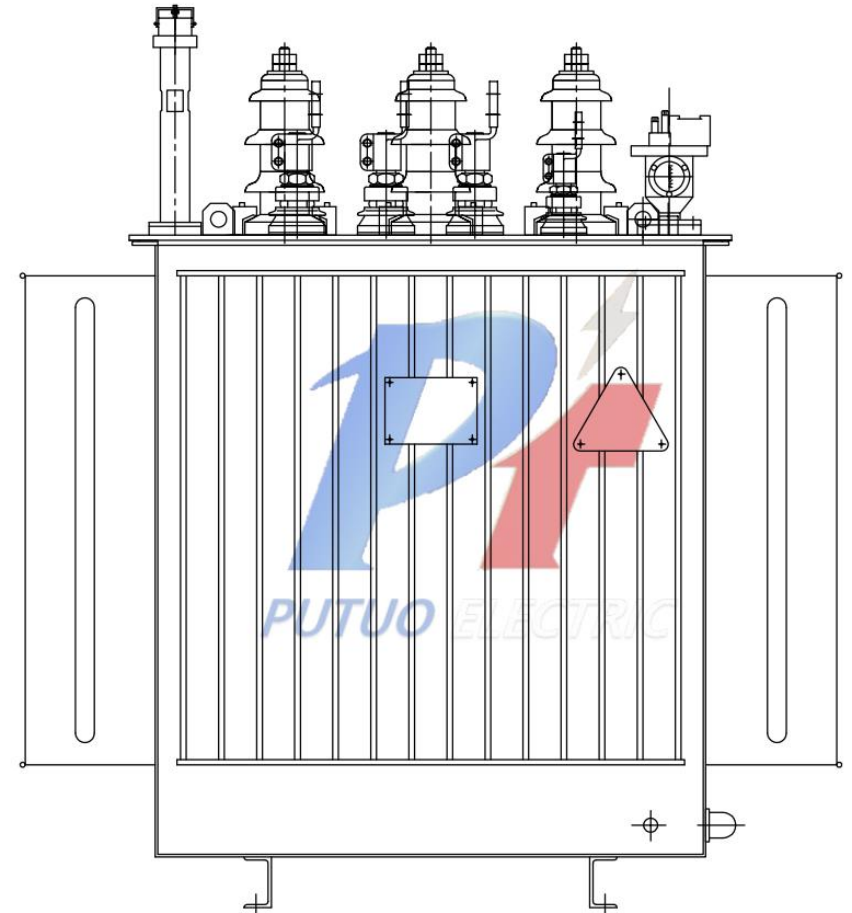

Outline drawing of several popular hermetic oil immersed distribution transformers

- S11-250kVA-6,10,11kV hermetic oil immersed distribution transformers····1
- S11-315kVA-6,10,11kV hermetic oil immersed distribution transformers····2
- S11-400kVA-6,10,11kV hermetic oil immersed distribution transformers····3
- S11-500kVA-6,10,11kV hermetic oil immersed distribution transformers····4
- S11-630kVA-6,10,11kV hermetic oil immersed distribution transformers····5
- SL11-800kVA-6,10,11kV hermetic oil immersed distribution transformers ···6
- S11-1000kVA-6,10,11kV hermetic oil immersed distribution transformers ···7
- SL11-1250kVA-6,10,11kV hermetic oil immersed distribution transformers··8
- SL11-1600kVA-6,10,11kV hermetic oil immersed distribution transformers··9
- S11-2000kVA-6,10,11kV hermetic oil immersed distribution transformers ···10
- S11-2500kVA-6,10,11kV hermetic oil immersed distribution transformers ···11



1PT.710.2009

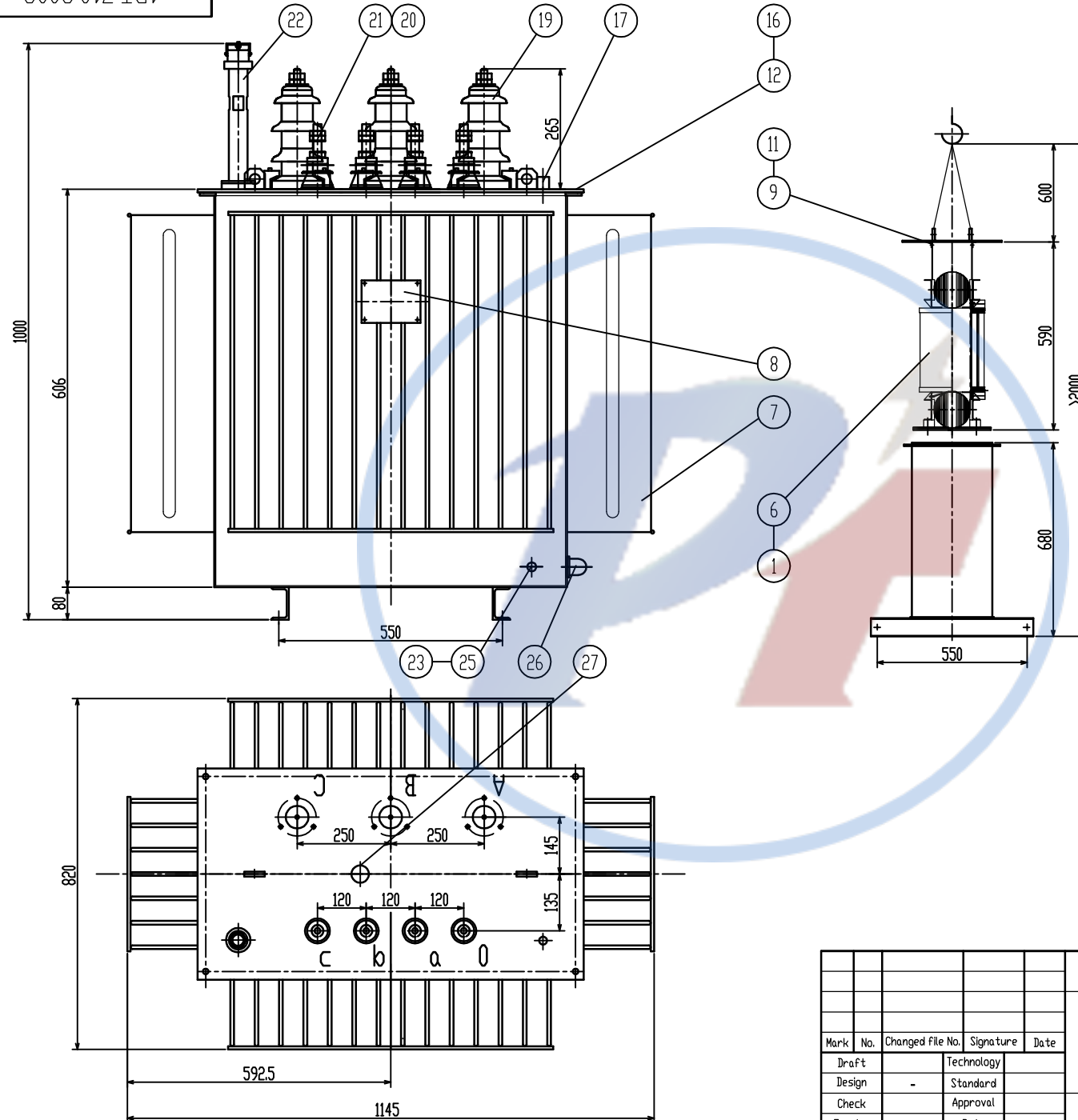

Weight List (kg)		
Oil	Body	Total

HV terminal

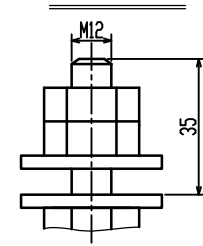

LV terminal

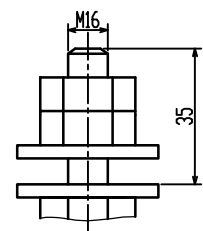

Used for

Mark	No.	Changed File No.	Signature	Date
Draft				
Design	-			
Check				
Examine				

S11-M-250/6,10,11
Transformer
Uk=4%
Dyn11

1PT.710.2009		
Pattern Mark	W. (KG)	Proportion
S A		
1 Page In Total		Page 1
Putuo Electric		

1PT.710.2010

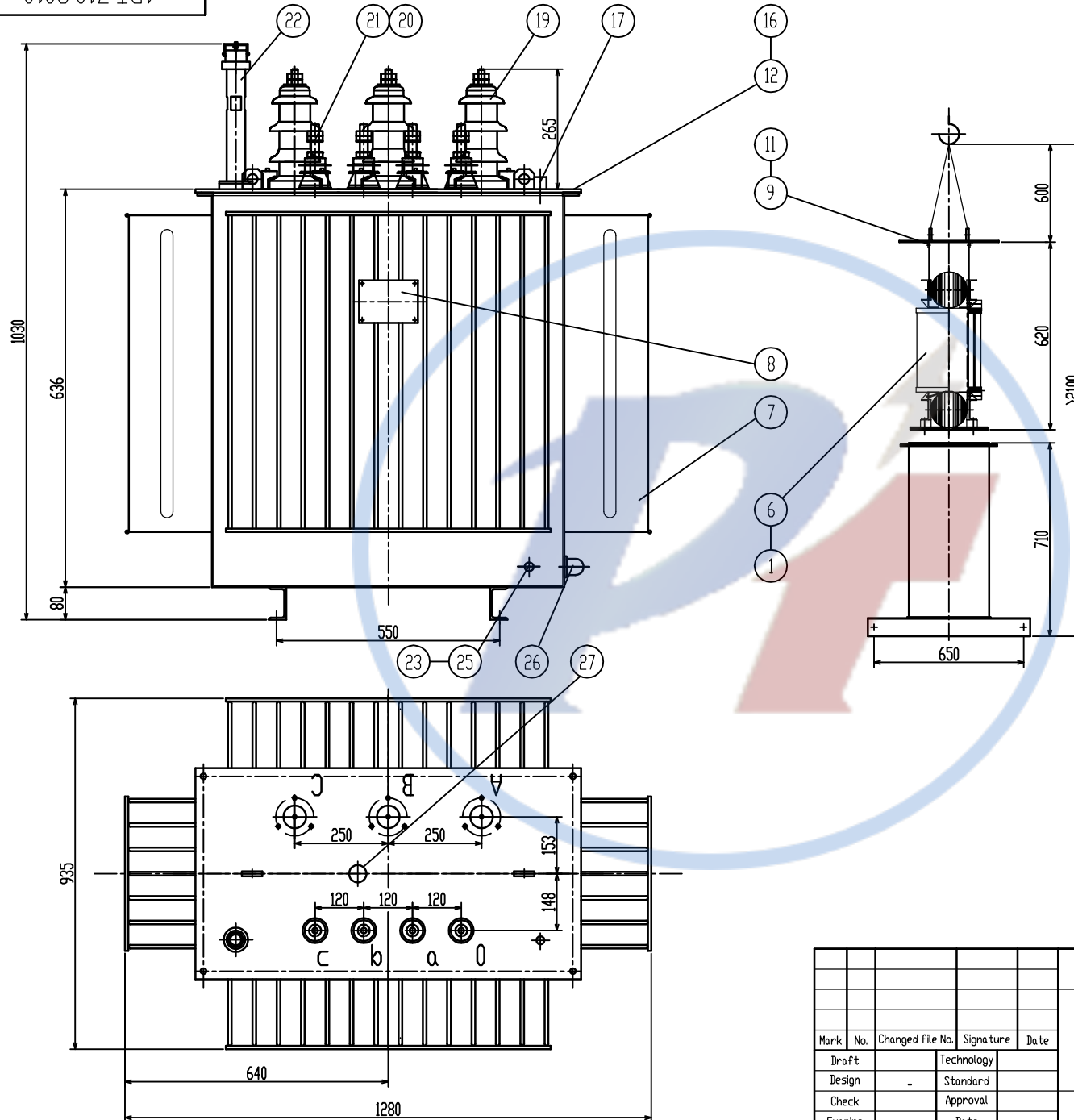

Weight Sheet		
□□	Body	Total
141	575	920

LV terminal

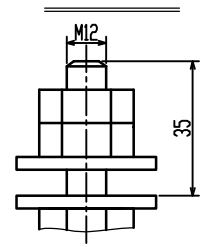

LV terminal

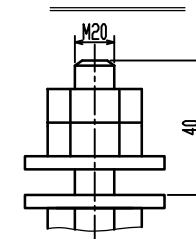

0-phase terminal

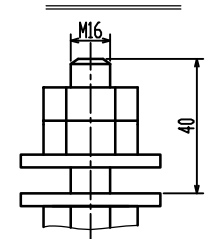

Used for

				S11-M-315/6,10,11		1PT.710.2010		
				Transformer 6,10,11/0.4 Uk=4% Dyn11				
Mark	No.	Changed file No.	Signature	Date	Pattern Mark		W. (KG)	Proportion
Draft			Technology		S A			
Design			Standard		1 Page In Total		Page 1	
Check			Approval					
Examine			Date				Putuo Electric	

1.710.2011

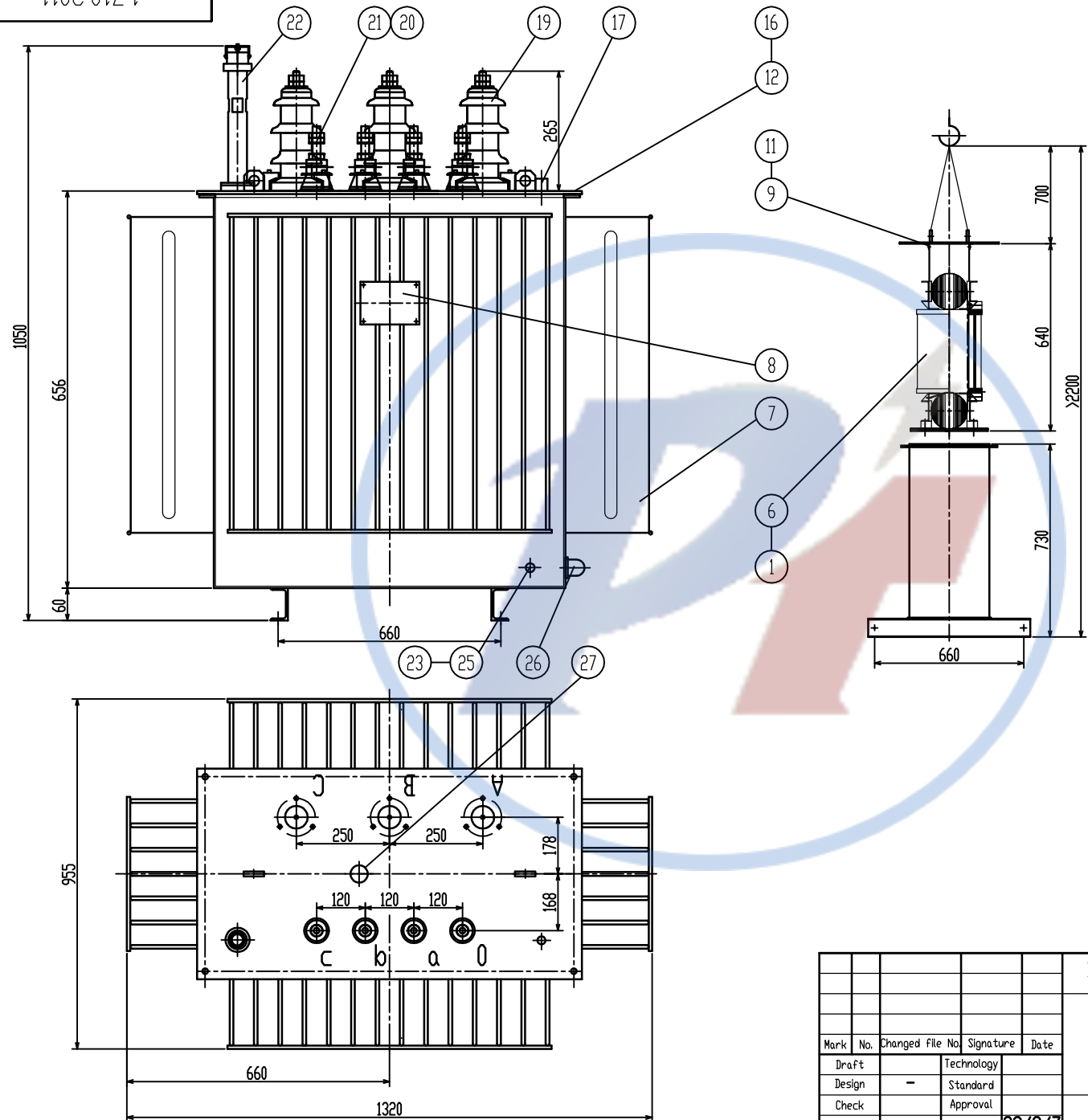

Weight Sheet		
Oil	Body	Total
165	740	1130

LV terminal

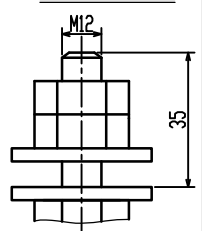

LV terminal 0-phase terminal

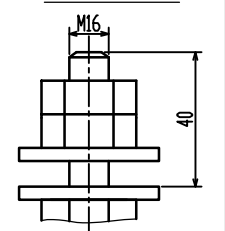
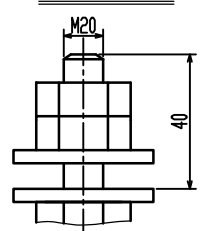

Used for

S11-M-400/6,10,11				1.710.2011			
Transformer				Pattern Mark		W. (KG)	Proportion
				S A			
Uk=4%				1 Page In Total		Page 1	
Dyn11				1PT.710.2010			
Mark	No.	Changed	File No.	Signature	Date		
Draft				Technology			
Design	-			Standard			
Check				Approval			
Examine				Date	22/9/77		

1PT.710.2012

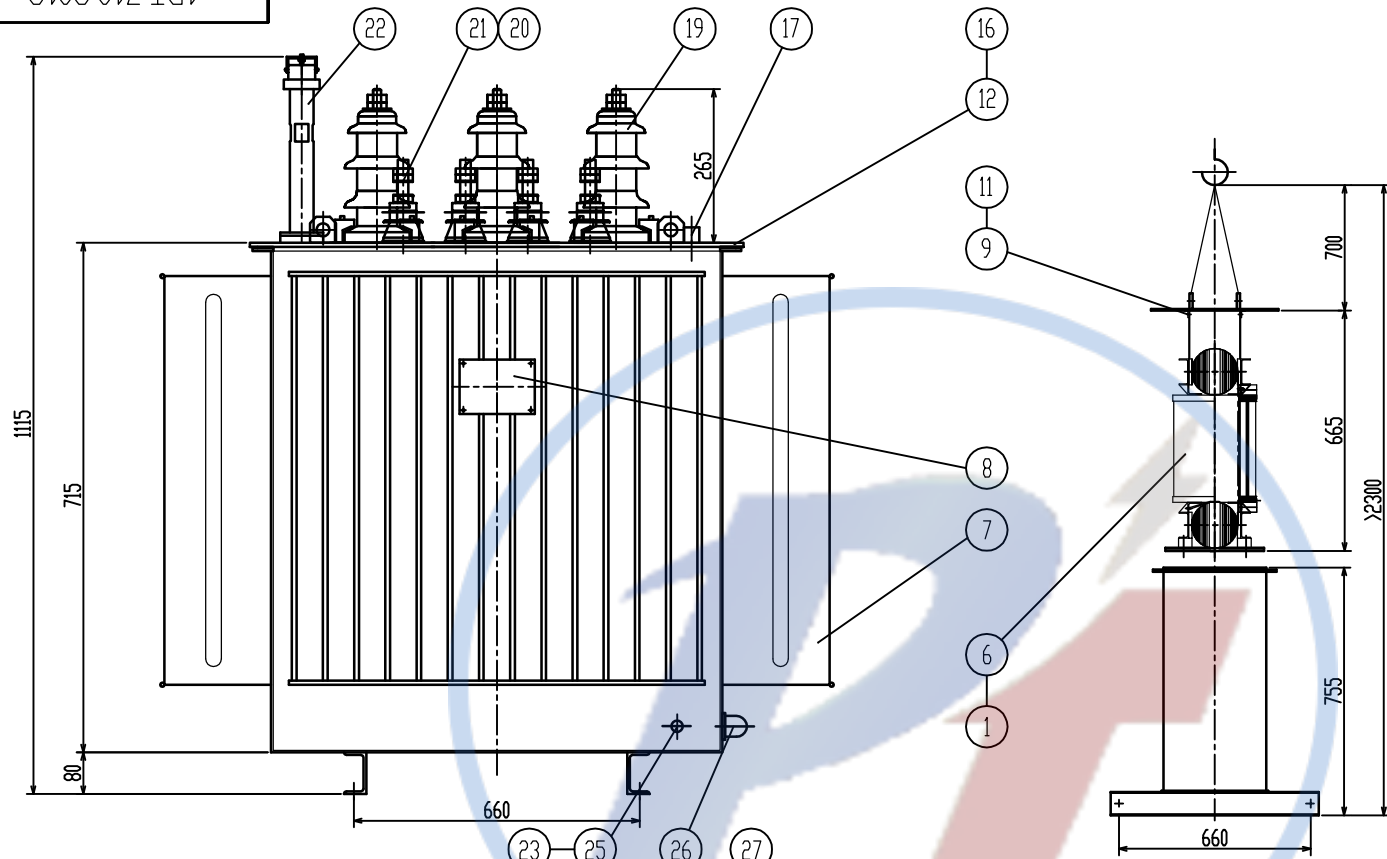

Weight List (kg)		
Oil	Body	Total
183	815	1270

HV terminal

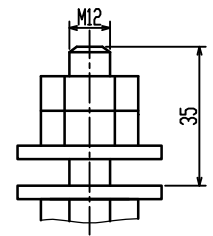

LV terminal

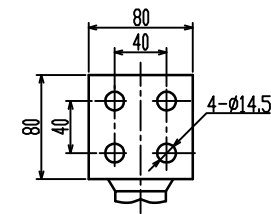

0-ph terminal

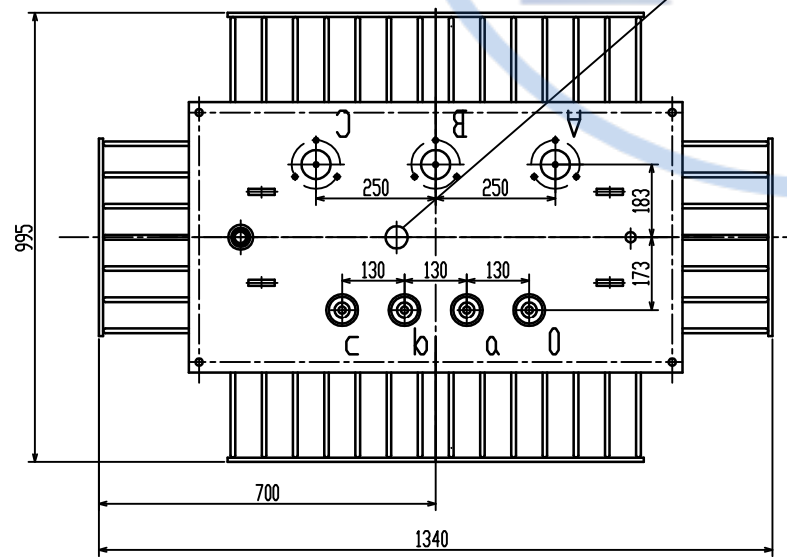
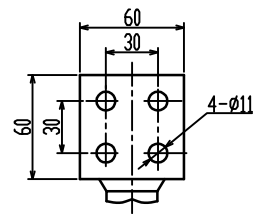

Used for

Mark	No.	Changed file No.	Signature	Date
Draft				
Design				
Check				
Examine				

S11-M-500/6,10,11

Transformer

Uk=4%

Dyn11

1PT.710.2012

Pattern Mark	W. (KG)	Proportion
--------------	---------	------------

S	A	
1 Page In Total		Page 1

Putuuo Electric

1.710.2013

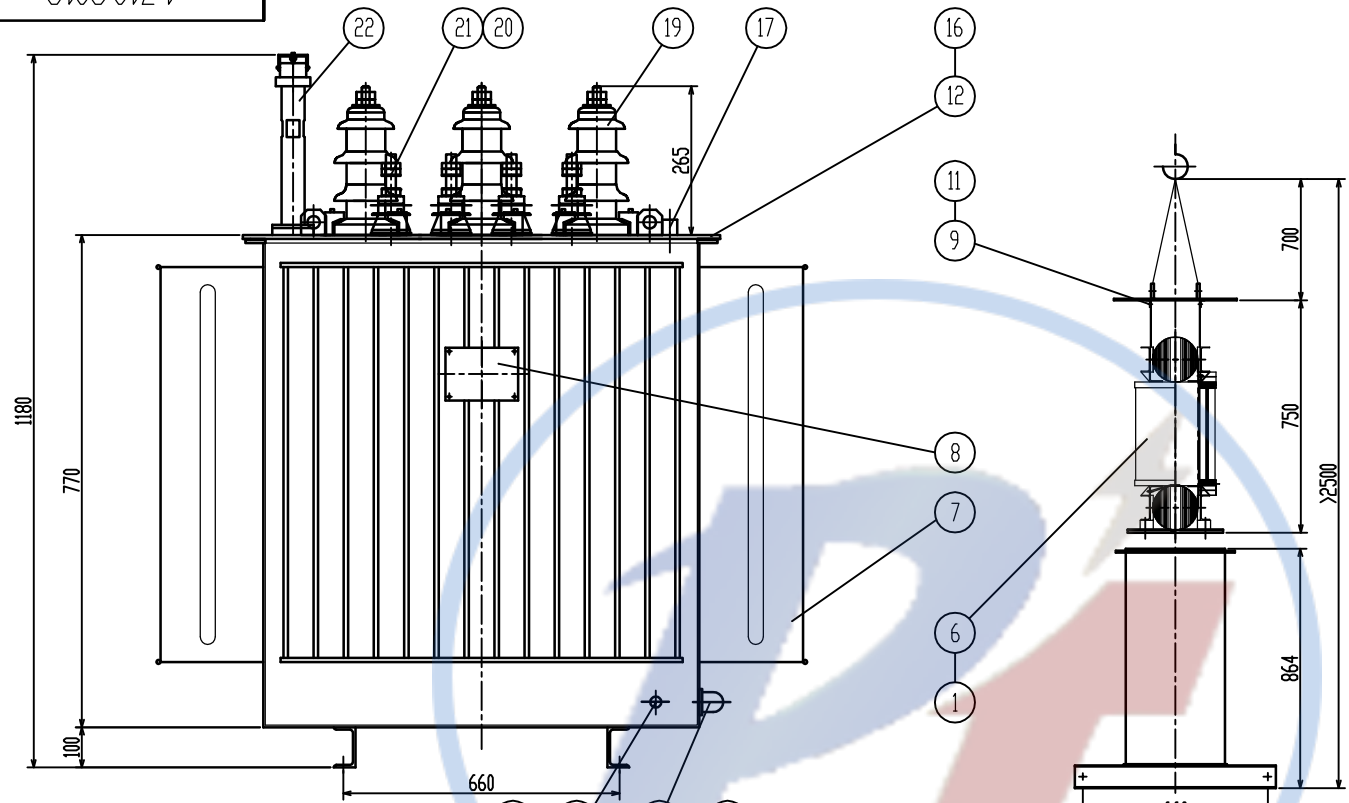

Weight List (kg)		
Oil	Body	Total
237	990	1540

HV terminal

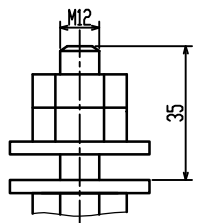

LV terminal

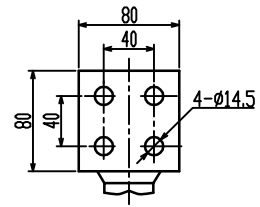

0-ph terminal

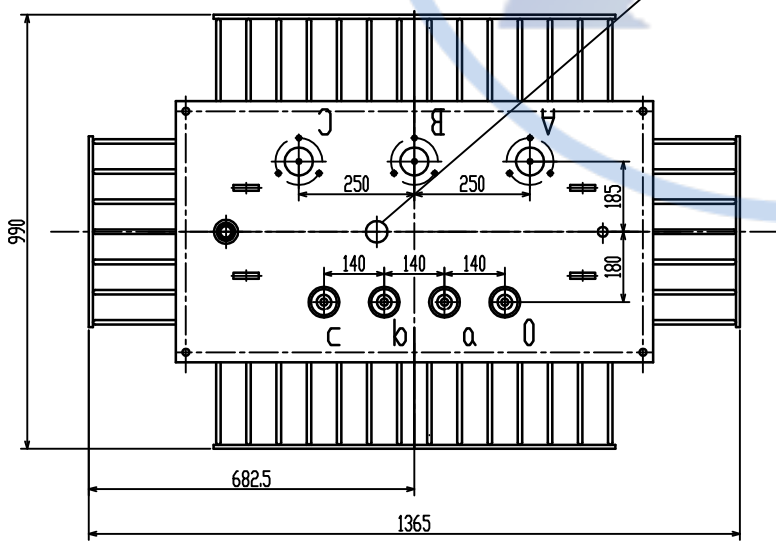
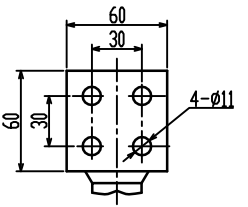

Used for

S11-M-630/6,10,11					1.710.2013		
Transformer					Pattern Mark		
6,10,11/0.4 Uk=4.5%					W. (KG)		
Dyn11					Proportion		
Date 22/12/8					1 Page In Total		
					Page 1		
					Putuo Electric		

1PT.710.2114

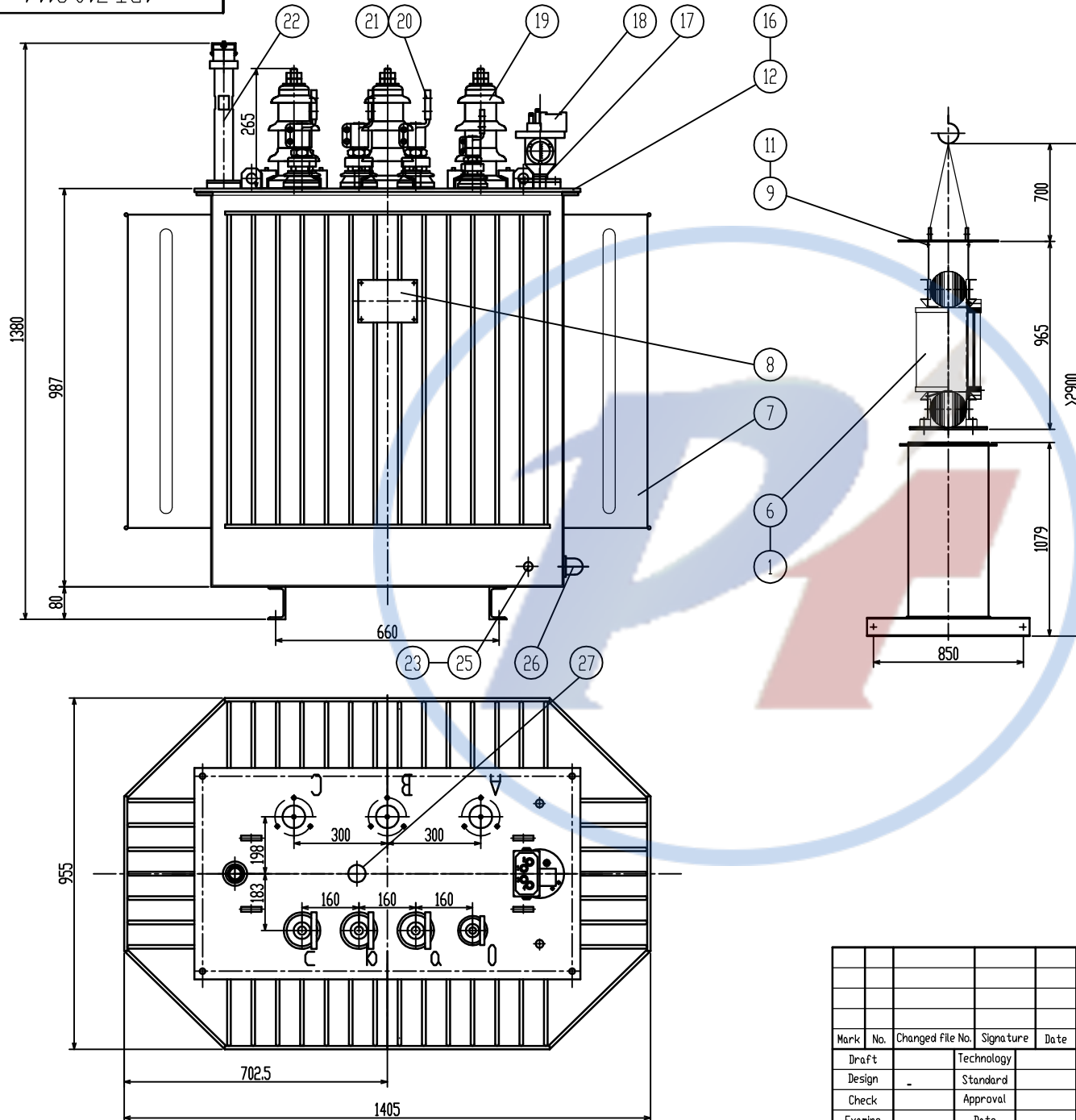

Weight Sheet (kg)		
Oil	Body	Total
282	1220	1900

HV terminal

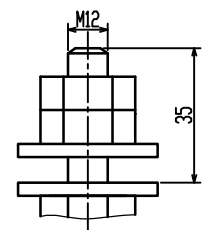

LV terminal

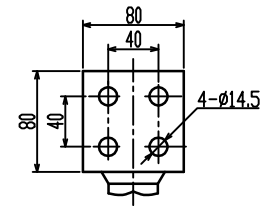

Ø-ph terminal

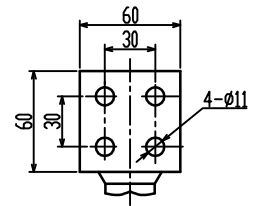

Used for

					SL11-M-800/6,10,11		1PT.710.2114	
					Transformer		Pattern Mark	
					Uk=4.5%		W. (KG)	
					Dyn11		Proportion	
Mark	No.	Changed file No.	Signature	Date			S A	
Draft			Technology				1 Page In Total	
Design			Standard				Page 1	
Check			Approval				Putuo Electric	
Examine			Date					

1PT.710.2015

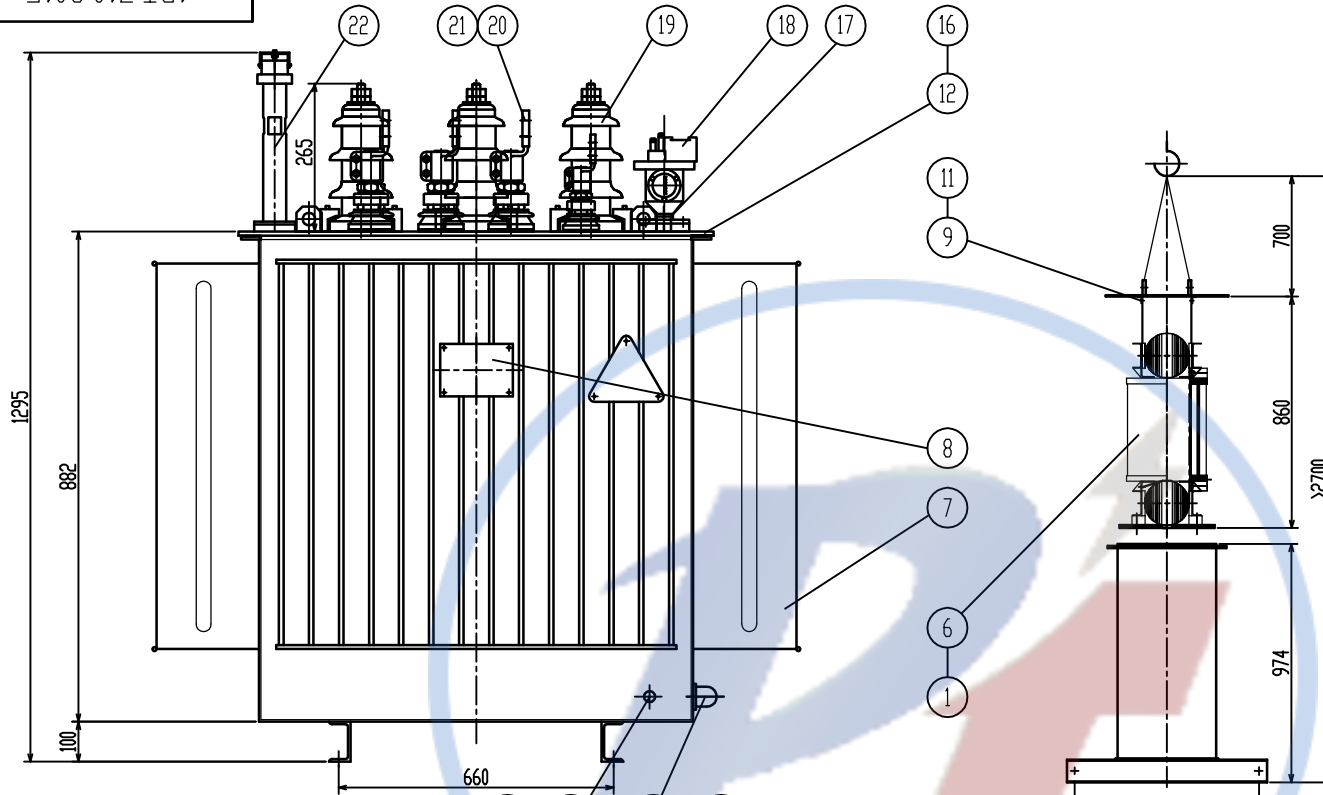

Weight List (kg)		
Oil	Body	Total
322	1245	2020

HV terminal

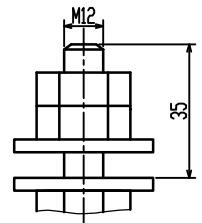

LV terminal

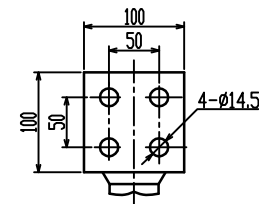

0-ph terminal

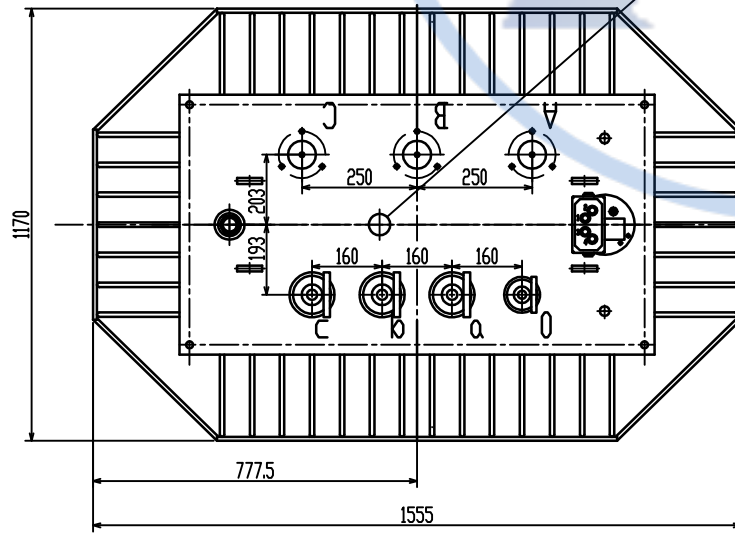
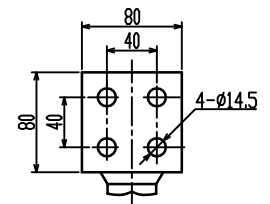

Used for

				S11-M-1000/6,10,11		1PT.710.2015	
				Transformer		Pattern Mark	
				Uk=4.5%		W. (KG)	
				Dyn11		Proportion	
Mark	No.	Changed file No.	Signature	Date	S A		
Draft			Technology		1 Page In Total		
Design			Standard		Page 1		
Check			Approval		Putuo Electric		
Examine			Date	20/6/28			

1PT.710.2116

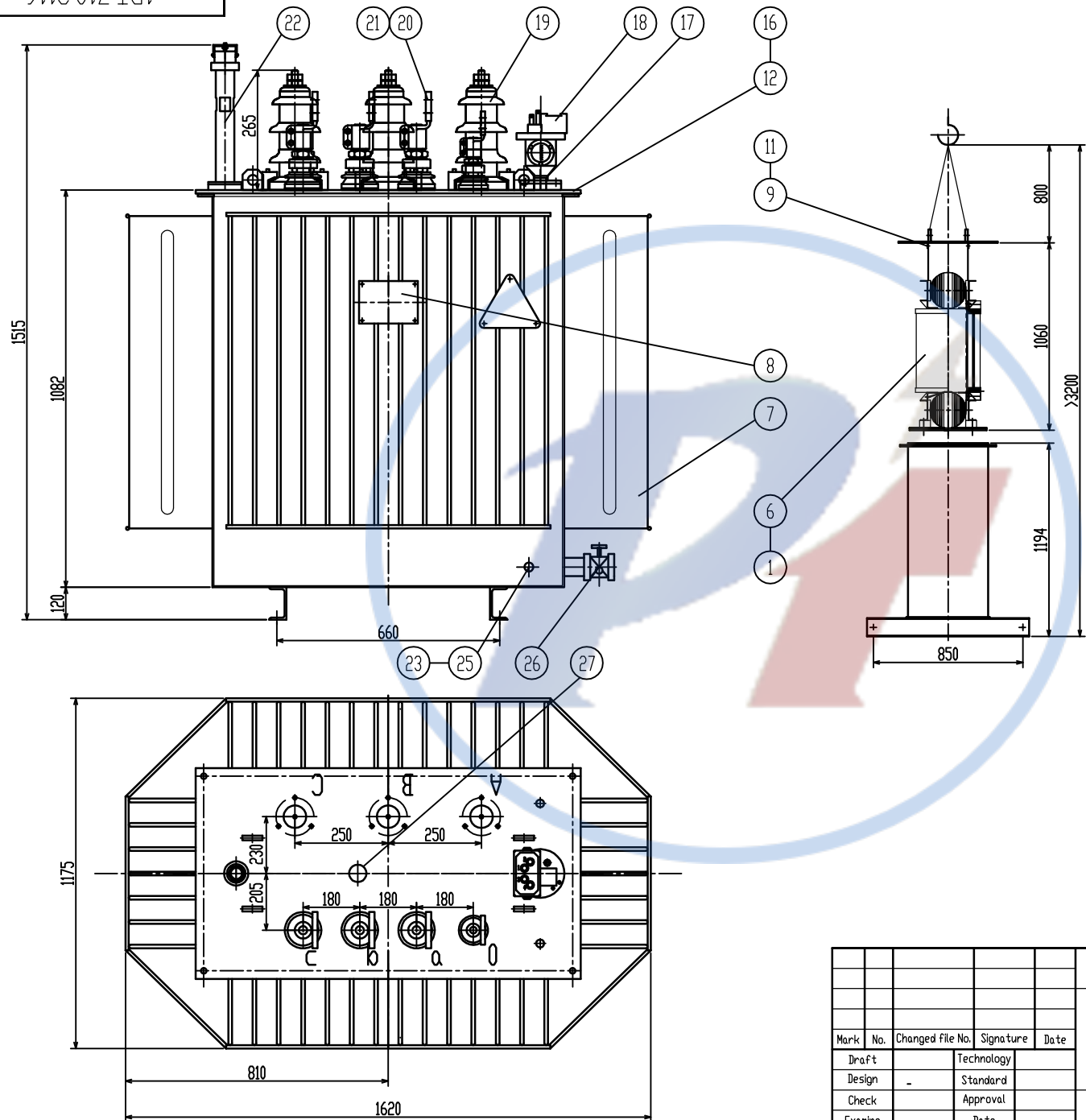

Weight Sheet (kg)		
Oil	Body	Total
378	1595	2540

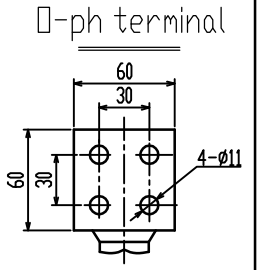
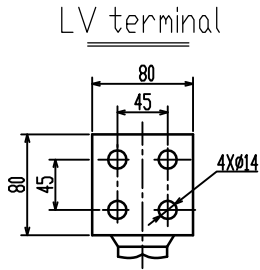
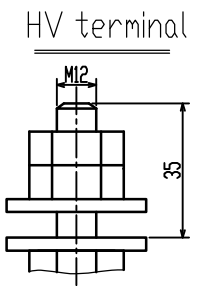

Used for

				SL11-M-1250/6,10,11		1PT.710.2116	
				Transformer			
				Uk=4.5%			
				Dyn11		Putuo Electric	
Mark	No.	Charged file No.	Signature	Date		Pattern Mark	W. (KG)
Draft						S A	
Design						1 Page In Total	Page 1
Check							
Examine							

1.710.1217

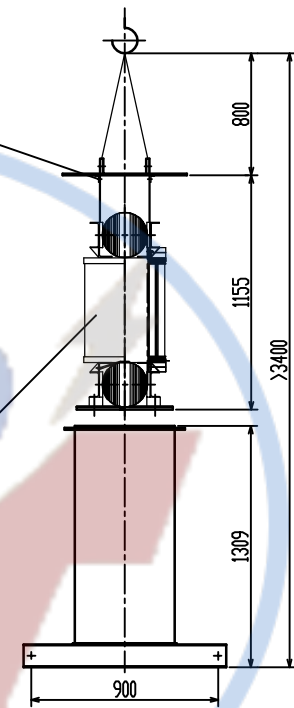
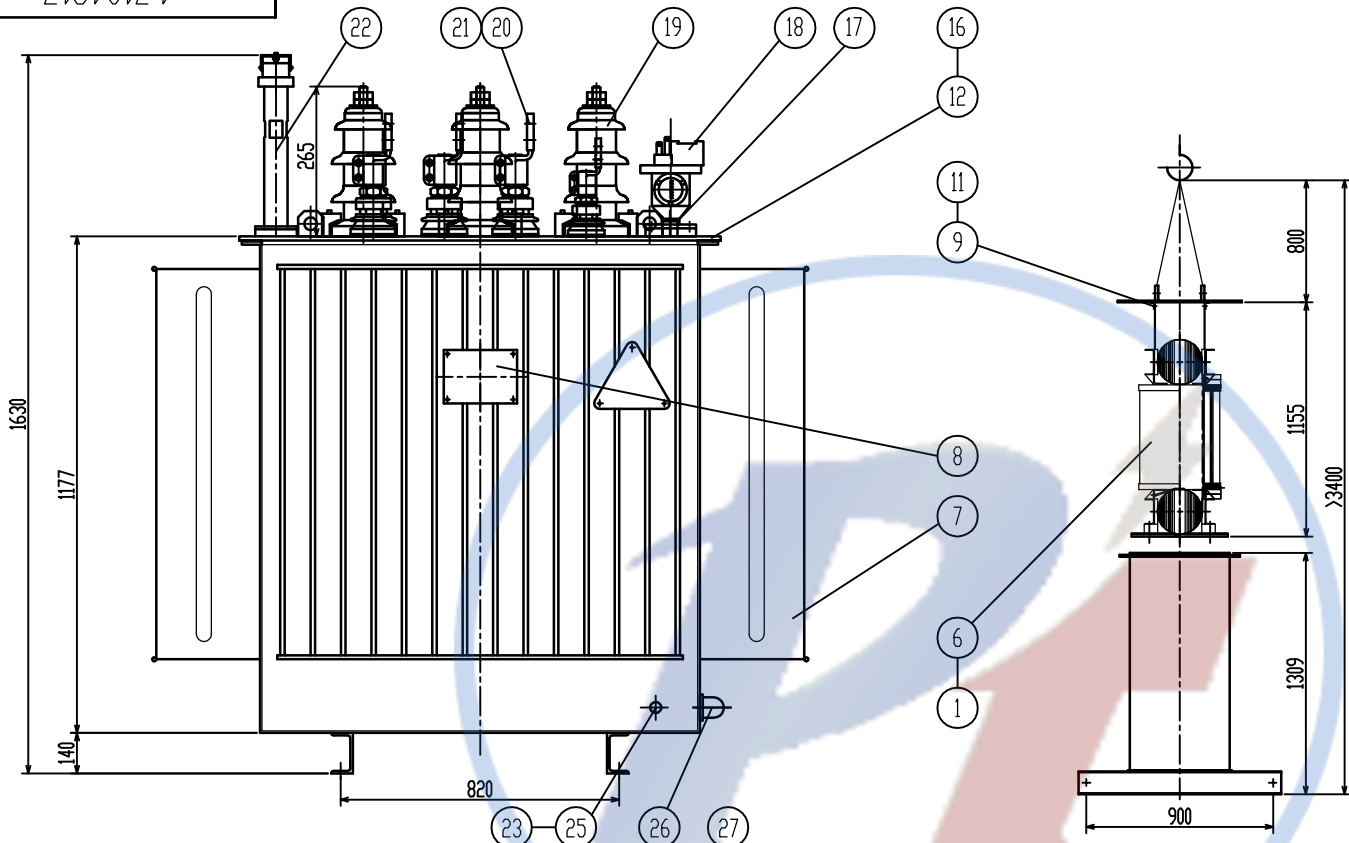

Weight Sheet (kg)		
Oil	Body	Total
459	1995	3120

HV terminal

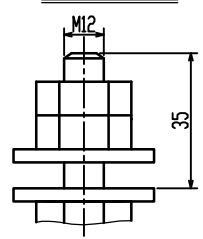

LV terminal

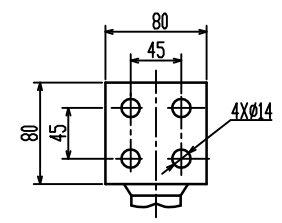

□-ph terminal

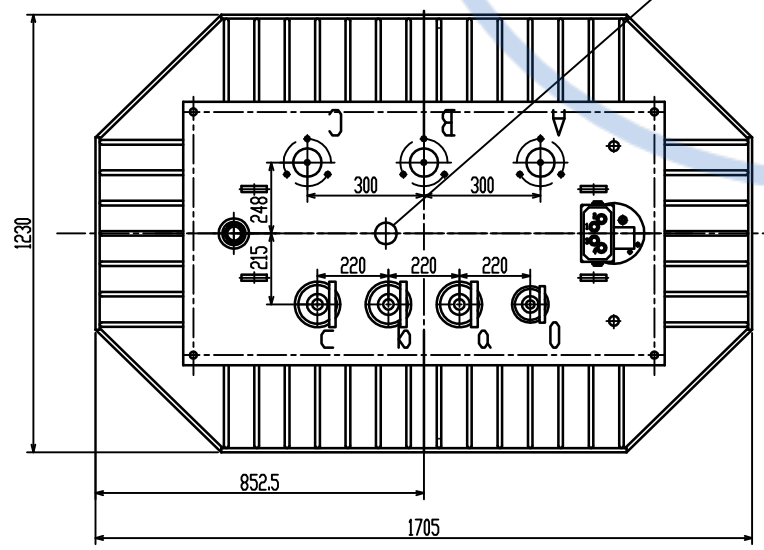
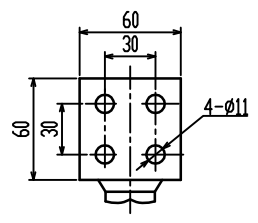

Used for

Mark	No.	Changed File No.	Signature	Date
Draft			Technology	
Design			Standard	
Check			Approval	
Examine			Date	

SL11-M-1600/6,10,11
Transformer
Uk=4.5%
Dyn11

1.710.1217		
Pattern Mark	W. (KG)	Proportion
S A		
1 Page In Total	Page 1	
Putuo Electric		

1HB.710.2018

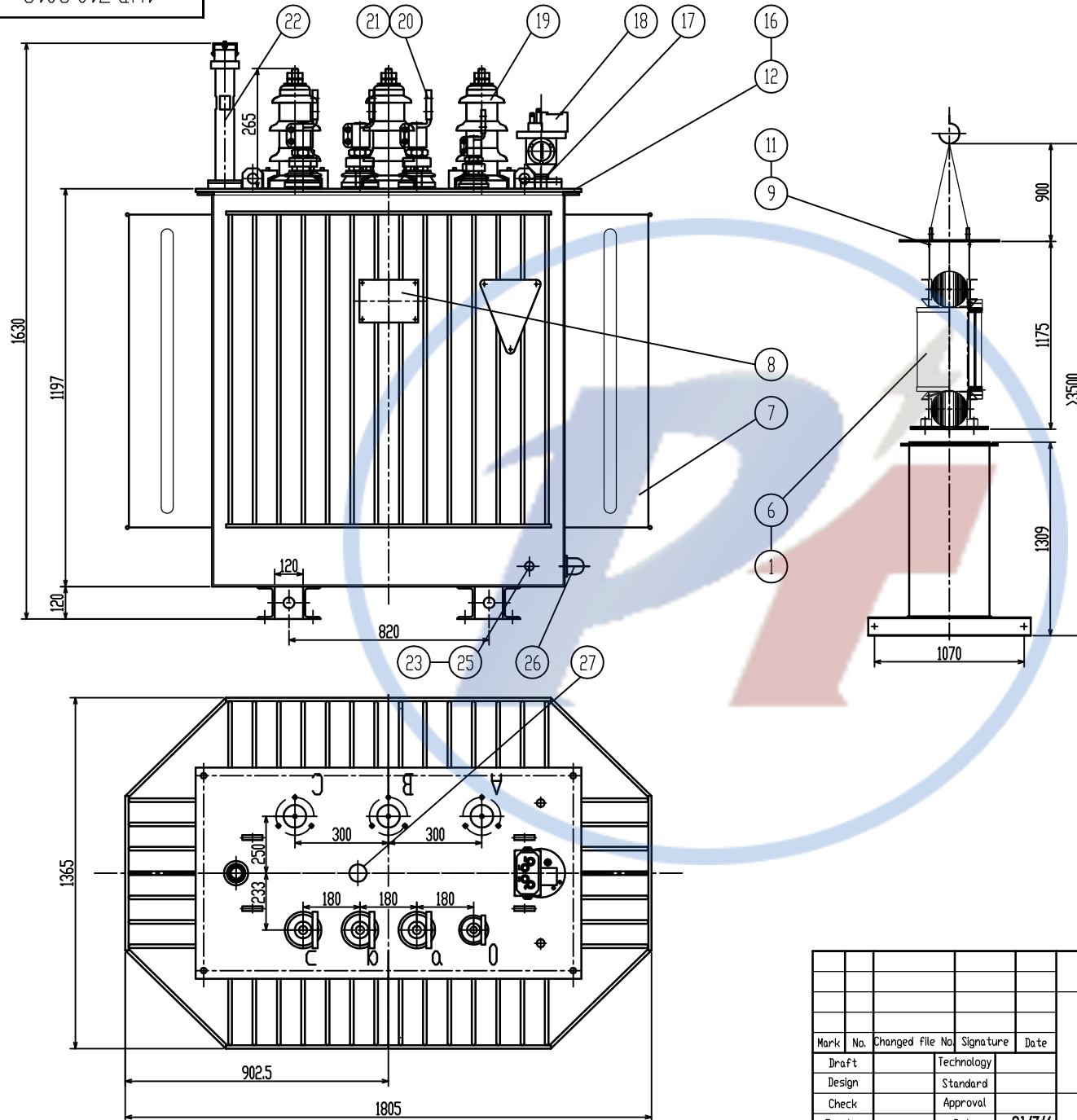

Weight List (kg)		
Oil	Body	Total
613	2190	3580

HV terminal

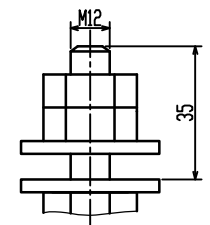

LV terminal

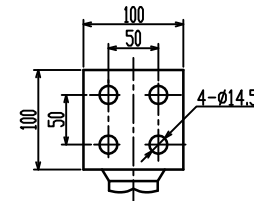

0-ph terminal

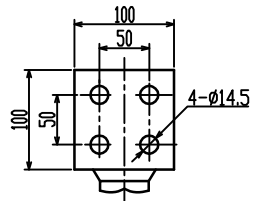

Used for

					S11-M-2000/6,10,11		1HB.710.2018		
					Transformer				
					Uk=5%				
					Dyn11		Putuo Electric		
Mark	No.	Changed file No.	Signature	Date					
Draft			Technology						
Design			Standard						
Check			Approval						
Examine			Date	21/7/16					
							Pattern Mark	W. (KG)	Proportion
							S	A	
							1 Page In Total	Page 1	

1PT.710.2019

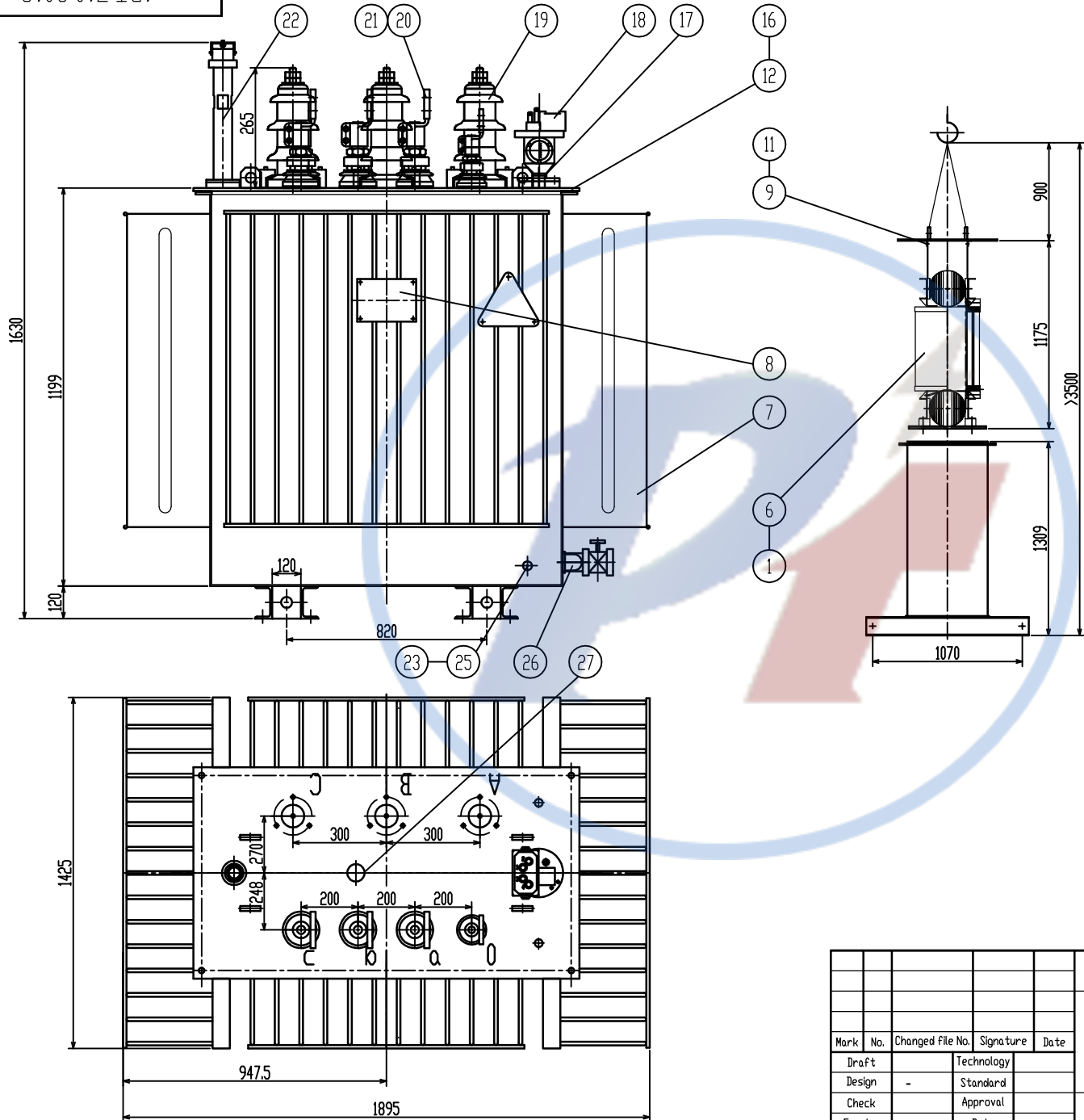

Weight List (kg)		
Oil	Body	Total
706	2725	4540

HV terminal

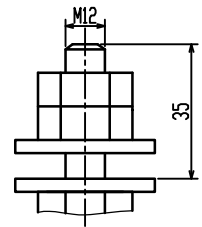

LV terminal

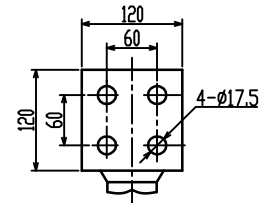

0-ph terminal

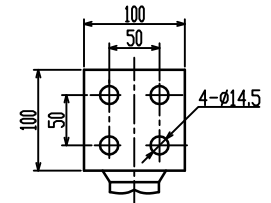

Used for

					S11-M-2500/6,10,11		1PT.710.2019		
					Transformer		UK=5%		
					Dyn11		Putuo Electric		
Mark	No.	Changed File No.	Signature	Date			Pattern Mark	W. (KG)	Proportion
Draft			Technology				S A		
Design			Standard				1 Page In Total		Page 1
Check			Approval						
Examine			Date						